

STEP1. ATTACH MOUNT TO WORK SURFACE

INSTALL ON OPEN EDGE
OF WORK SURFACE:

Slide the Base Stem against
work surface edge and fully
tighten clamp Screw(A).

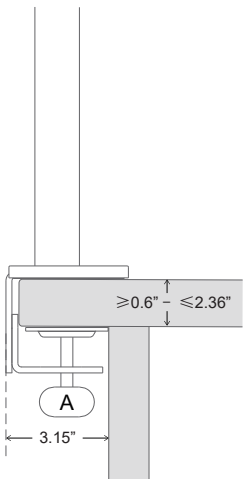

STEP2. INSTALL THE ADAPTOR

- 1 Remove the screw from the
adapter by the hex wrench.

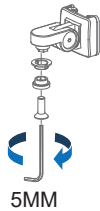

- 2 As the picture shows, put the
accessories at the arm, tighten
the screw.

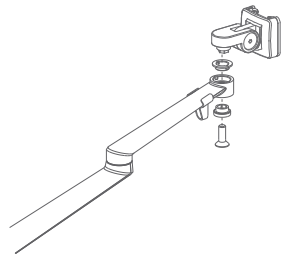

Note: If you would like to lower
the height, Please detach
the arm bracket firstly(A), Then
insert arm as picture.

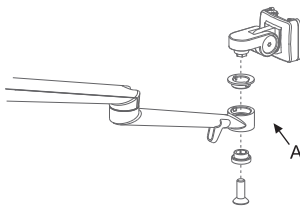

STEP3. ATTACH ARM TO THE POLE

As the picture shows, install clip → arm → clip → arm → post cap
in order.

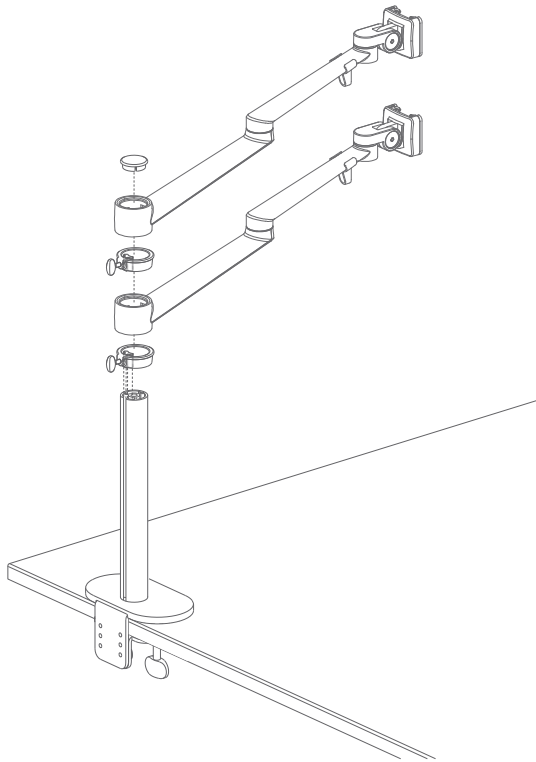

HEIGHT ADJUSTMENT

The Clip could be adjusted on
your desired position by loosening
the screw(A), fix it.

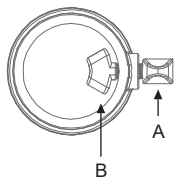
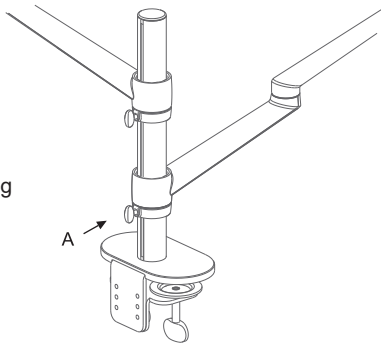

Note: Please fix the inside nut of
post(B) in position before tighten
Screw(A) on the clip.

STEP4. ATTACH MONITOR/LAPTOP PLATE TO ARM

INSTALLING MONITOR

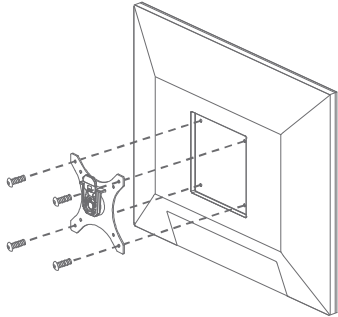

- 1 As the picture shows,
install VESA mount on
monitor. Be careful to
leave the slide clip
upwards.

VESA standard:
75*75mm ; 100*100mm

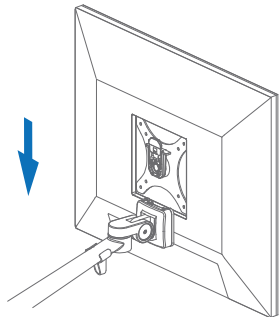

- 2 Insert the VESA
connector into the
groove, when heard a
click sound means done.

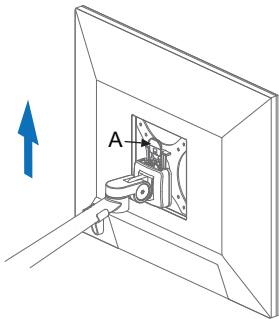

Note: If you want to
remove the device,
please press shrapnel
(A) to remove the
device Up to extract.

INSTALLING LAPTOP PLATE

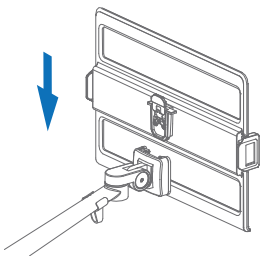

Insert the Laptop Plate into
the groove, when heard a
click sound means done.

STEP5. CABLE MANAGEMENT

- 1 Remove cable clip (A) from
the arm, thread cables, install
cable clip on the arm again.

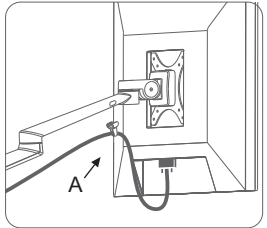

Note: Open cable clip two sides.

- 2 Slide the plastic cover on the rear arm upwards until it
disengages. Put cables onto the plastic cover inside. Slide
the cover downwards until it click into place.

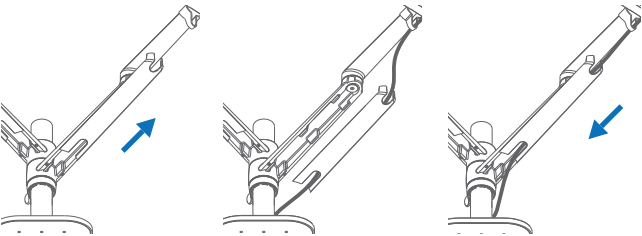

ARM ADJUSTMENTS



TENSION ADJUSTMENT

If you feel the pitching angle too tight or too loose when
adjusting the mount, please adjust the Screw.

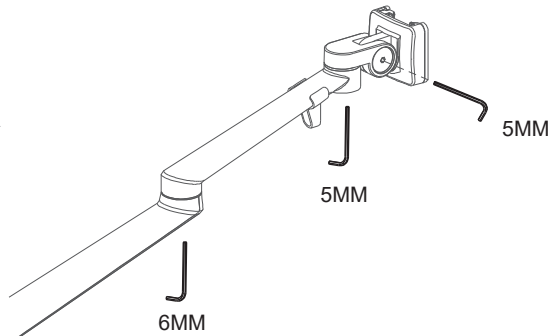

INSTALLATION HARDWARE

WARNING

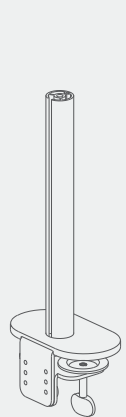

X 1
Base Stem



X 2
Arm



X 2
Clip



X 2
Adaptor

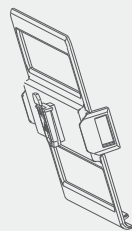

X 1
Laptop Plate



X 1
VESA Connector



X 6
Screws (M4)



X 6
Screws (M5)



X 1
Post Cap



4 / 5 / 6mm
Hex Wrench

- * Make sure to read the manual before installation and fully understand how to install, if you have any questions, please visit our website or contact our service email for the help.
- * Please make sure the desktop could bear the weight of mount and monitor before installation.
- * This product contains small parts, keep these away from children.

WARRANTY SERVICE

Never worried when you choose viozon products We offer the best after-sale service to our customer, it only takes few minutes.

Just send you name and order number to



US: service@vio-zon.com
EU: support@vio-zon.com

And then you will get a complete service like The installation guide, Technical support, New product iteration, buy New similar products in advance , promotions, and warranty service from Viozon.

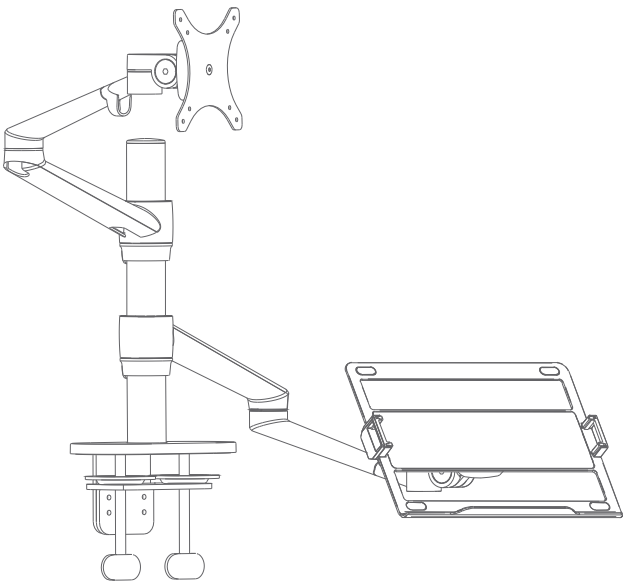

viozon®

FEEDBACK

Share it?
Let us know with a customer review.

Viozon is focus on high-standard product, we believe Customer drive our product upgrades. And write a review that sharing your experience will help other customers , and this will give us great encouragement and confidence.

And if you have any questions, please feel free to contact us without hesitate.

FOR HELP PLEASE CONTACT US:



Facebook: Viozon



US: service@vio-zon.com
EU: support@vio-zon.com



www.vio-zon.com



Scan QR code
to get install video



Scan QR code below for
more products from viozon

OL-3L
Installation
Instructions