

Aputure Lantern User Manual

Thanks for purchasing Aputure product.

Aputure Lantern is a new Aputure softbox accessory, Universal Bowens mount design, makes it compatible with LS COB series LED light(LS c120d, 120d II, 300d...),The Omni-directional Soft Light output and flexible barn doors feature, can support more lighting layout option.

Install/unlock

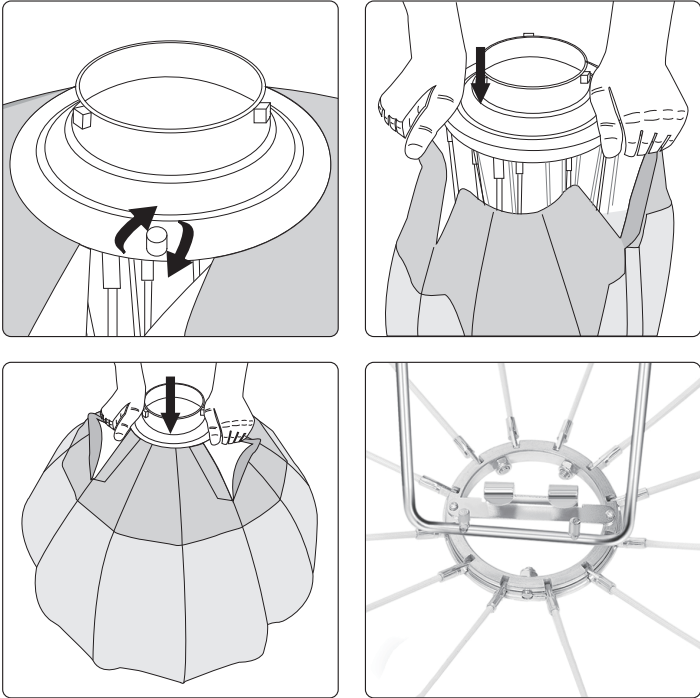

Attach to light fixture

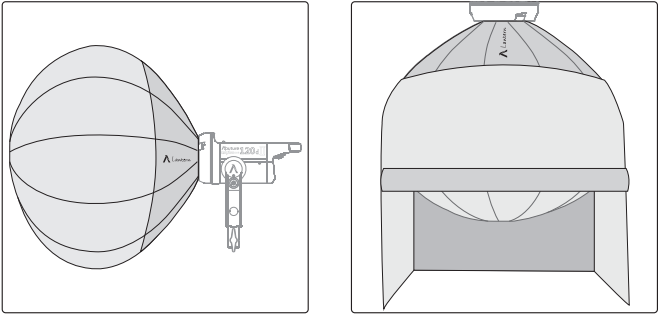

Main Features

- 1. Universal Bowens Mount.
- 2. Flexible Fabric 4-leaf Barn Doors.
- 3. 1-stop Fabric Diffusion.
- 4. Omni-directional Soft Light Output

Package includes

- 1. Lantern Spring Cage x1
- 2. Diffusion x1
- 3. Fabric Barn Doors x1
- 4. Carry Bag x1

Specification

Product Unfold Dimension	650x650x560mm/25.5x25.5x22"
Product Collapsed Dimension	180x180x810mm/7x7x32"
Box Dimension	185x185x835mm/7.3x7.3x32.9"
Weight	2.76kg/6.09lbs
Diffusion Stops	1-stop

Detailed product manual for Lantern can be found on www.aputure.com

Aputure® | GUARANTEE CARD

Service Warranty (EN)

Aputure Imaging Industries Co., Ltd warrants the original consumer purchaser from defects in material and workmanship for a period of one (1) year after the date of purchase. For more details of warranty visit www.aputure.com

Important: Keep your original sales receipt. Be sure the dealer has written on it the date, serial No. of the product. This information is required for warranty service.

This warranty does not cover:

- Damage that is the result of misuse, abuse, accident (including but not limited to damage by water), faulty connection, defective or maladjusted associated equipment, or the use of the product with equipment for which it was not intended.
- Cosmetic defects that appear more than thirty (30) days after the date of purchase. Cosmetic damage caused by improper handling is also excluded.
- Damage that occurs while the product is being shipped to whoever will service it.

This warranty is void if:

- The product identification or serial No. label is removed or defaced in any way.
- The product is serviced or repaired by any one other than Aputure or an authorized Aputure dealer or service agency.

Aputure Imaging Industries Co., Ltd.
Add: F/3, Building 21, Longjun Industrial estate,
Heping West Road, Shenzhen, Guangdong
E-MAIL: cs@aputure.com
Sales Contact: (86)0755-83285599-613

感谢购买爱图仕产品。

爱图仕灯笼是一款全新爱图仕柔光附件，接口形式维持通用的保荣口设计，可以通用现有的LS系列点光源，全指向柔光输出，配上独有的软遮扉设计，可以完成更多布光需求。

安装/拆卸

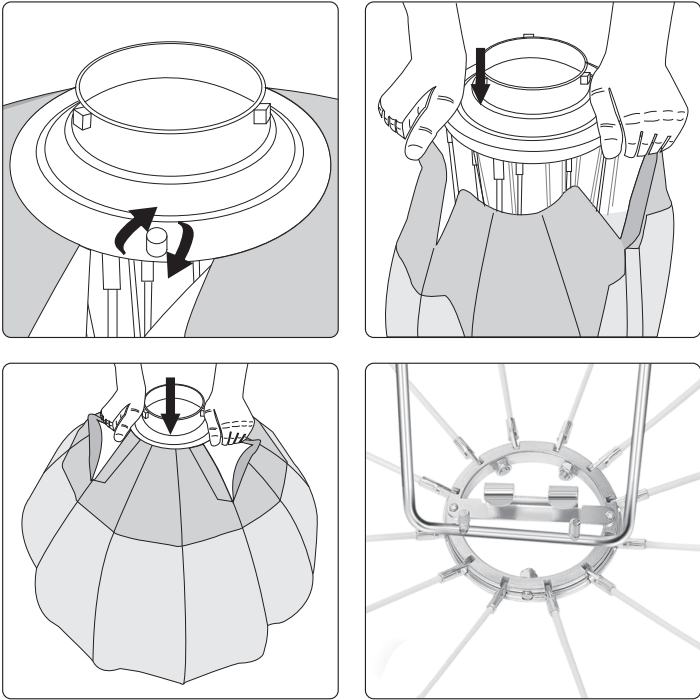

灯笼安装到灯上

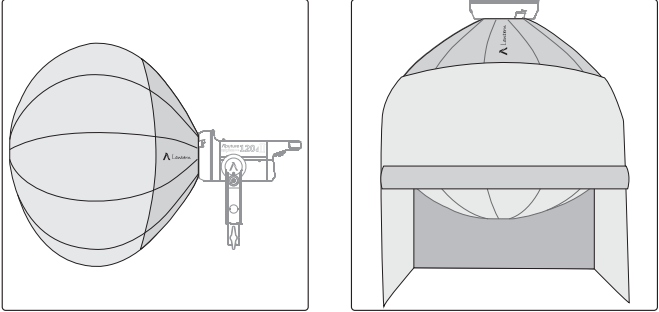

主要功能

- 1. 通用保荣卡口接口；
- 2. 柔性4叶挡光板；
- 3. 1档减光柔光布；
- 4. 全指向发光。

包装清单

- 1. 灯笼架子 x1
- 2. 灯笼布 x1
- 3. 柔性遮扉 x1
- 4. 手提包 x1

产品规格

灯笼展开尺寸	650x650x560mm/25.5x25.5x22"
灯笼收纳尺寸	180x180x810mm/7x7x32"
箱子尺寸	185x185x835mm/7.3x7.3x32.9"
重量	2.76kg/6.09lbs
柔光布减光	1档减光

您可以在本公司网站 <http://www.aputure.com/cn> 下载本产品的详细使用者指南。

Aputure® | 保修卡

保修条款 (中文)

本公司对产品第一类主客户提供为期一年的质量保证证明。质保内容和细节，请登陆我们的网站www.aputure.com

重要说明:

请保留原始购买单据及保修卡，确定您购买的供应商资料都在此单据，同时包括您的购买日期，产品序列号等，这些资料保质服务时都会需要提供。

质保范围不包括:

- 产品不当使用，破坏，意外，错误接线，不良或失调的外接装置，不适当的外接装置所造成的损坏（包括暴露于雨水等环境），不在质保范围。
- 自购买日30 天后产品外观的损坏，或是不当的柔面处理接触造成的外观损伤，不在质保范围。
- 经销售渠道所造成的损坏，不在质保范围。

质保无效说明:

- 产品序列号标识已经模糊或无法辨识，本质保条款无效
- 产品未经本公司或者指定授权维修公司的检修及改装，本质保条款无效

深圳市爱图仕影像器材有限公司
地址：广东省深圳市龙华区和平路101号工业21栋3楼
邮箱: cs@aputure.com
销售热线: 0755-83285599-613
服务热线: 400-0999-026

折页方式:

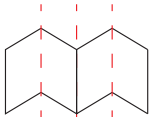

为折线(不印刷)

折页成型 (英文在正面) :



Aputure® 深圳市爱图仕影像器材有限公司			
设计项目	155说明书	图号	AP-155-PR-01
尺寸 (mm)	315*140mm 折页尺寸: 105*140mm	版本	V1.0
材质工艺	70g 书纸, 正反两面印刷	设计师	Ingrid
备注	料号:	日期	20190515