

## Waterproof 3 Cores Connector

### 3芯防水连接器

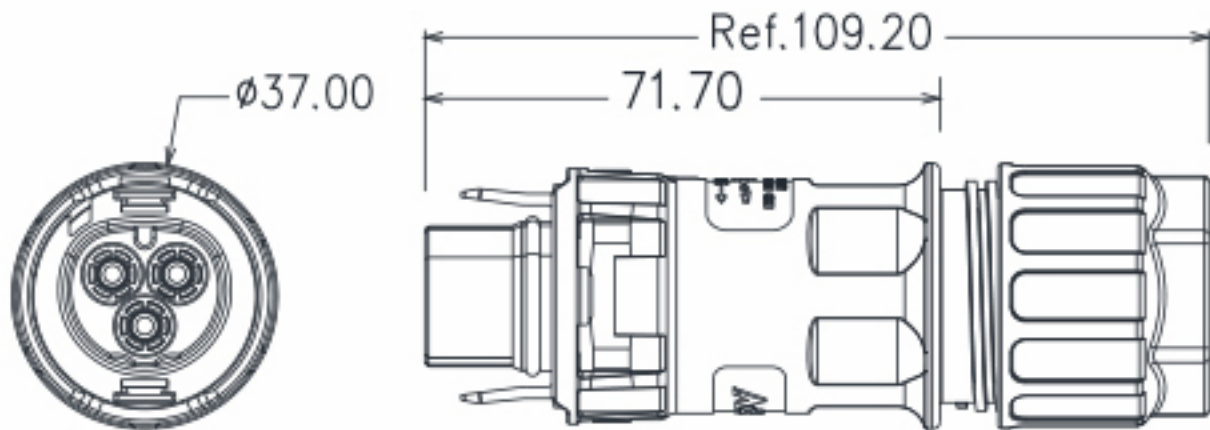

3PCF



3PCM

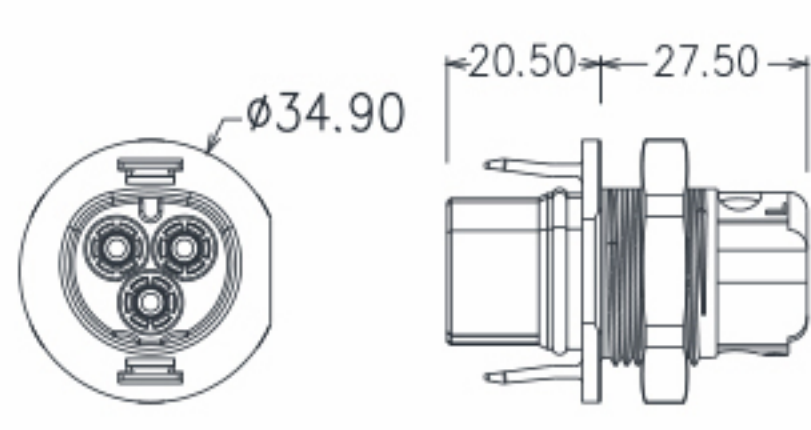

3PPF

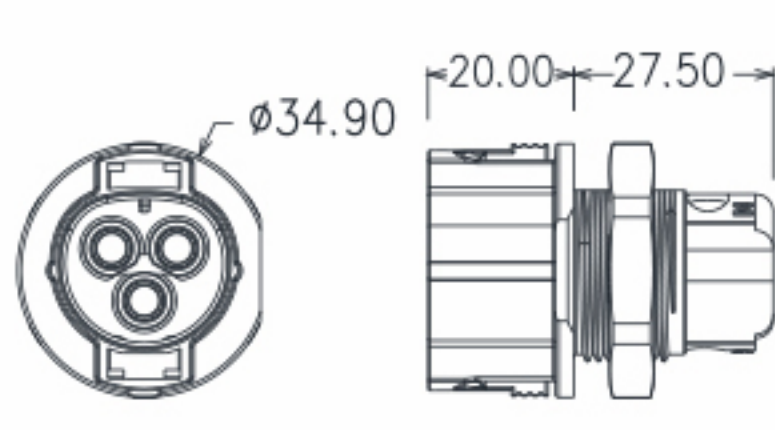

3PPM

## Waterproof 5 Cores Connector

### 5芯防水连接器

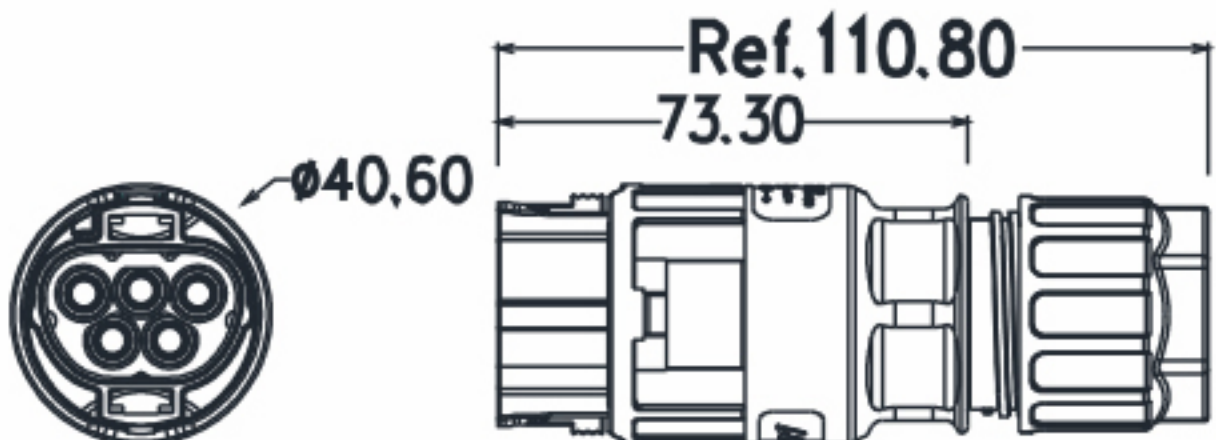

5PCF

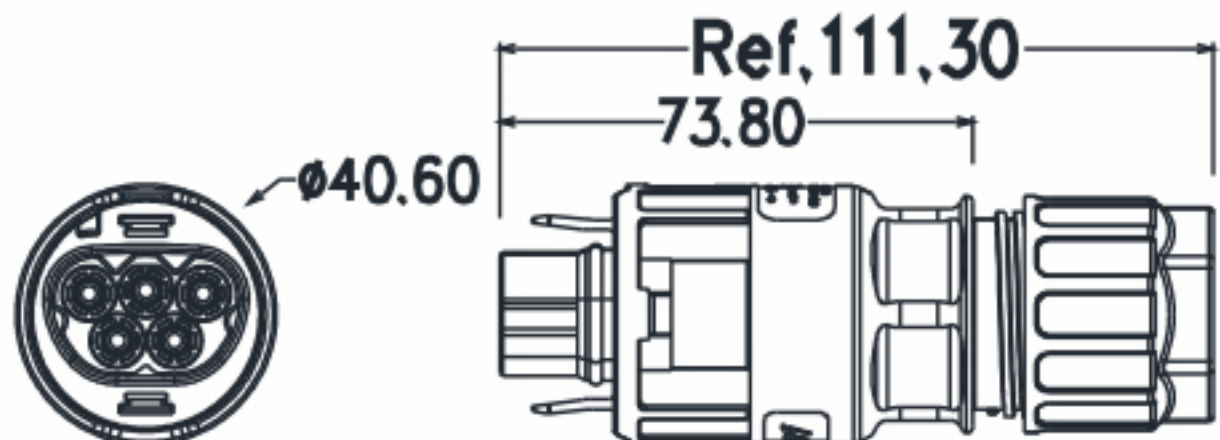

5PCM

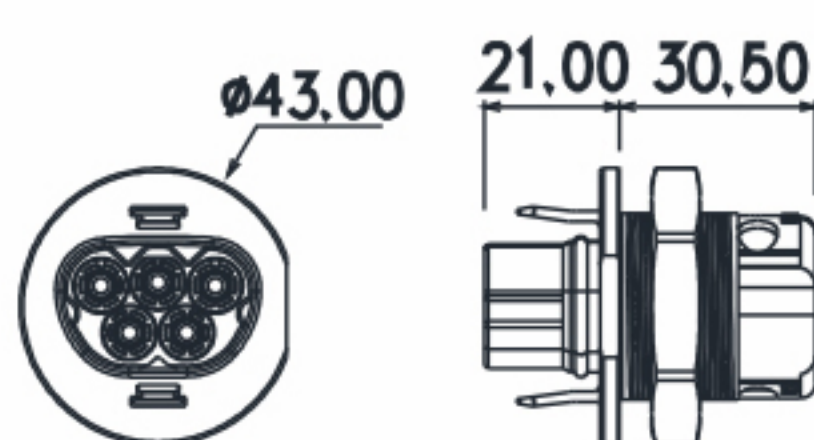

5PPF

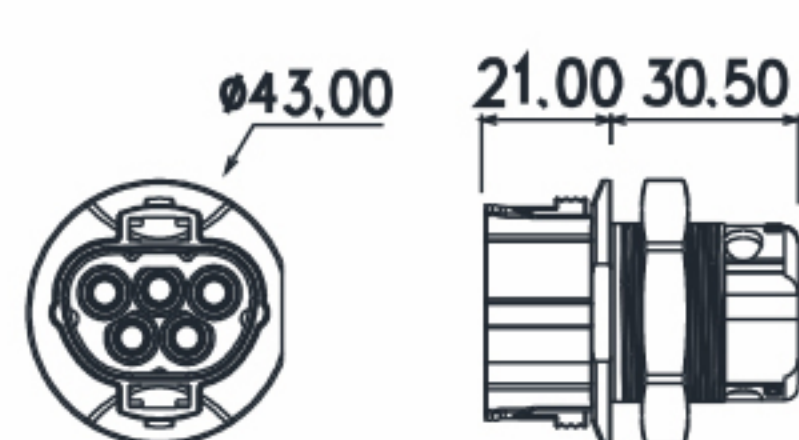

5PPM

### Product Specifications 产品规格

	3C	5C
绝缘材料 Insulation material	PPE/PA	PPE/PA
额定电流 Rated current	Max.50A	Max.50A
额定电压 Rated voltage	500V AC	500V AC
绝缘电压 Dielectric withstand voltage	4KV	4KV
接触阻抗 Typical contact resistance	≤5mΩ	≤5mΩ
导体材质 Contact material	铜,镀锡/Copper,Tin plated	铜,镀锡/Copper,Tin plated
保护等级 Degree of protection	IP68	IP68
防火等级 Flame class	UL94-V0	UL94-V0
接线方式 Contaction type	锁螺丝/铆接Screw/Crimp	锁螺丝/铆接 Screw/Crimp
导体尺寸mm/数量 Contaction Size/number of contact	Φ4*3	Φ4*5
环境温度范围 Ambient temperature range	-40℃ until +85℃	-40℃ until +85℃
适配电线规格 Suitable cable cross sections	2.5~10 mm <sup>2</sup>	2.5~10 mm <sup>2</sup>
电线最大外径 Suitable cable OD Max.	Φ18mm	Φ21mm
参考标准 Standard	UL2238/EN 61984/CE	UL2238/EN 61984/CE



**Waterproof 2/3/4/5 Cores Connector**

2/3/4/5芯 防水连接器

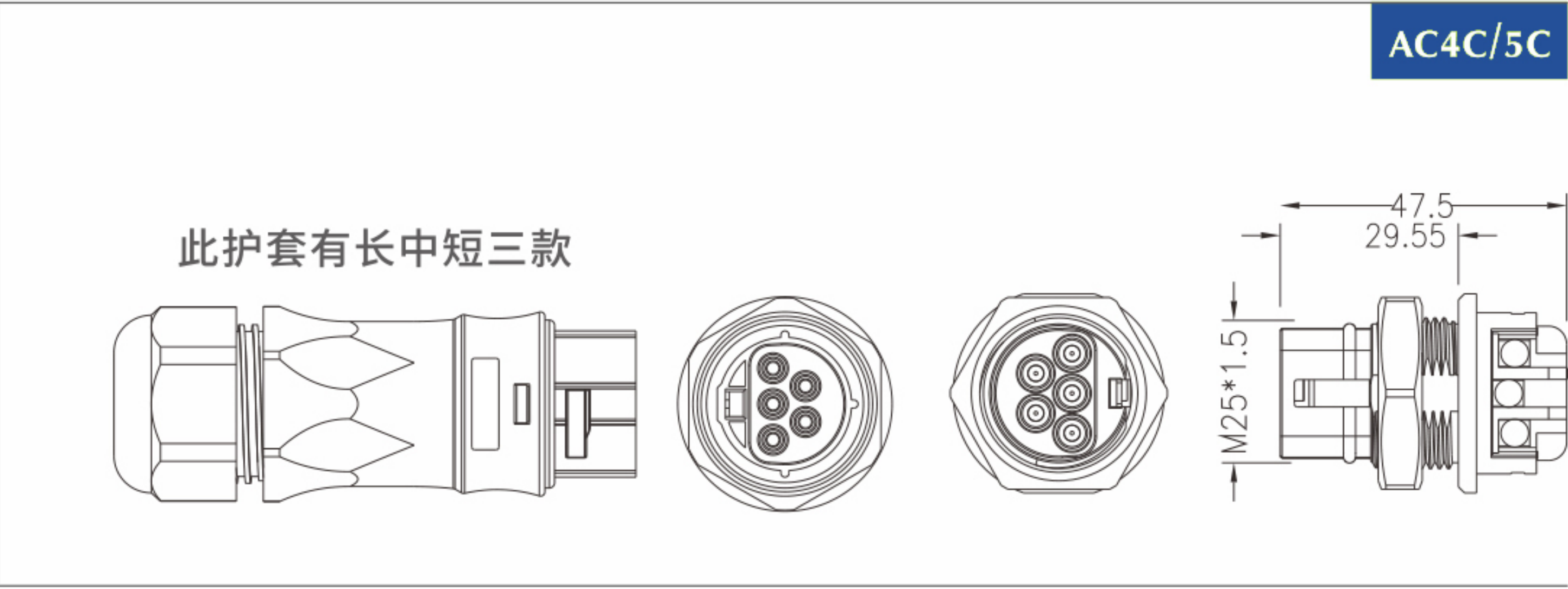
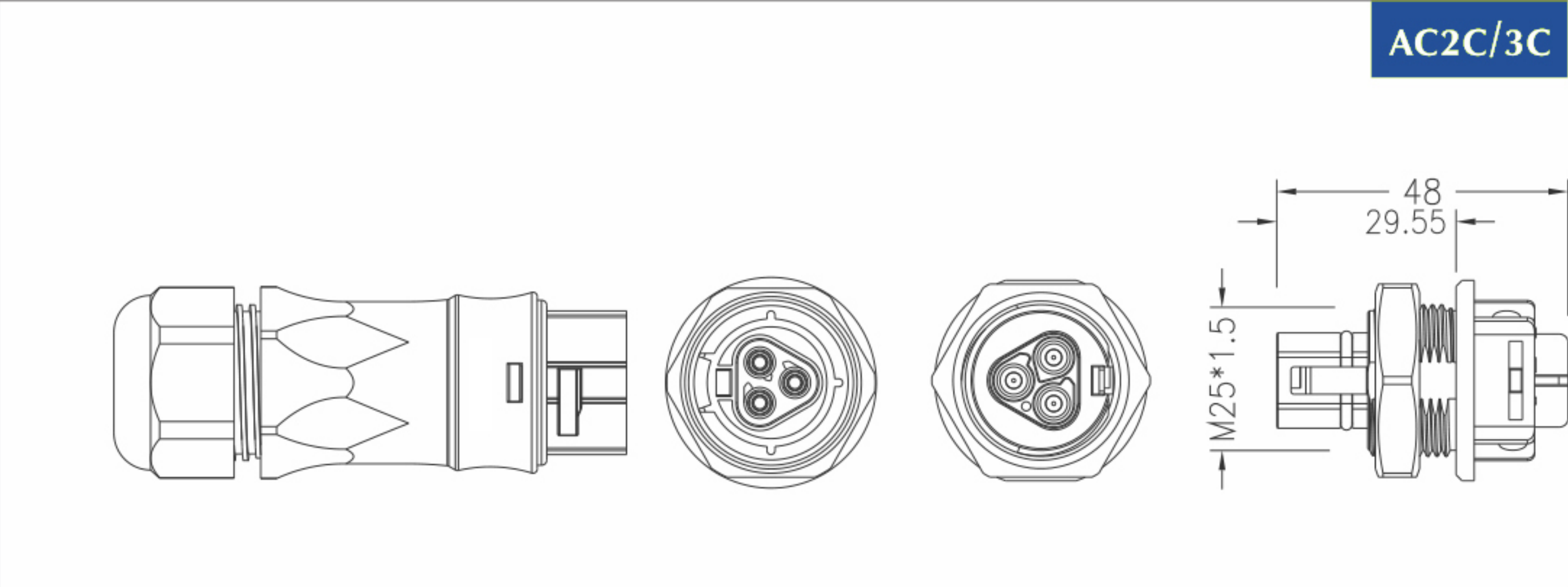

**Product Specifications**  
**产品规格**

	2C/3C	4C/5C
绝缘材料 Insulation material	PPE/PA	PPE/PA
额定电流 Rated current	Max.35A	Max.40A
额定电压 Rated voltage	500V AC	500V AC
绝缘电压 Dielectric withstand voltage	4KV	4KV
接触阻抗 Typical contact resistance	≤5mΩ	≤5mΩ
导体材质 Contact material	铜,镀锡/Copper,Tin plated	铜,镀锡/Copper,Tin plated
防水等级 Degree of protection	IP67	IP67
防火等级 Flame class	UL94-V0	UL94-V0
接线方式 Contaction type	锁螺丝/Screw	锁螺丝/Screw
导体尺寸/数量 Contaction Size/number of contact	Φ2.6*2/3	Φ2.6*4/5
环境温度范围 Ambient temperature range	-40℃ until +85℃	-40℃ until +85℃
适配电线规格 Suitable cable cross sections	2.5~6.0 mm <sup>2</sup>	2.5~10 mm <sup>2</sup>
电线最大外径 Suitable cable OD Max.	Φ18mm	Φ20mm
参考标准 Standard	UL2238/EN 61984/CE	UL2238/EN 61984/CE

