

Super Series A4-S

Super 系列:光伏铜线连接器 A4-S



IEC 1500V  
UL 1500V



UL: 6703  
IEC: 62852



-40 °C ~ 90 °C



UL94-V0



IP 68



UV Resistance



Product Overview 产品概述:

A4 Super connectors use high quality weather resistance materials that guarantee long-term reliability. A4-S could match 2.5mm<sup>2</sup> to 16mm<sup>2</sup> cables, it could be wildly used in different applications. The lower contact resistance and higher current transfer capability ensure high product efficiency. A4-S connectors have IP68 water-proof rating and can be used in a wide operating temperature range from -40 °C to 90 °C.

A4-S 系列连接器采用高品质绝缘耐候材料，可保障产品在户外长期安全使用。产品可适配 2.5 平方到 16 平方电线，具有更广的应用范围。较小的接触电阻和大电流传输能力保障了产品长期使用的可靠性。A4-S 系列连接器符合 IP68 额定标准，且能够工作在 -40 °C 到 90 °C 极限环境。

Technical Data 技术参数:

Rated Voltage 额定电压	IEC 1500V\UL1500V
Certification 执行标准	IEC 62852; UL 6703
Rated Current 额定电流	35A/40A/45A/55A/65A
Ambient 工作温度	-40°C up to +90°C
Contact Resistance 接触电阻	≤0.25mΩ
Pollution Degree 污染等级	Class II
Protection Degree 保护等级	Class II
Fire Resistance 阻燃等级	UL94-V0
Rated Impulse Voltage 额定浪涌电压	16KV
Locking System 锁扣	NEC Locking Type

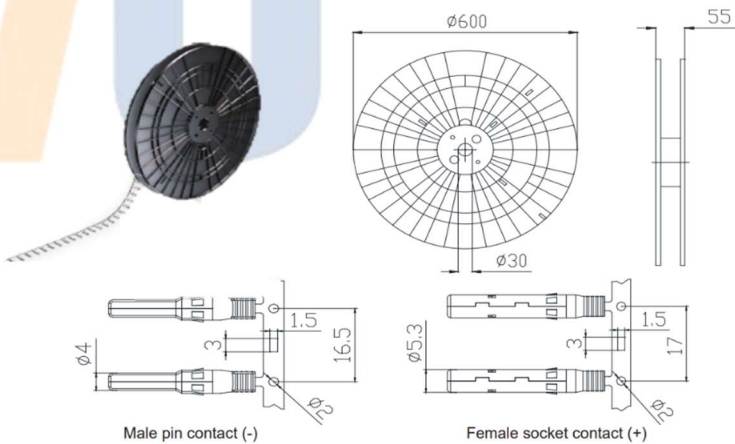

Order Data 规格信息:

Connector Male Housing 连接器负极本体选型表		Connector Female Housing 连接器正极本体选型表		Male Terminal 负极导体选型表		Female Terminal 正极导体选型表	
Part NO 料号	Cable OD 线径	Part NO 料号	Cable OD 线径	Part NO 料号	Cable 适用线缆	Part NO 料号	Cable 适用线缆
A4-M6 6 型负极本体	4.7mm~6.0mm	A4-F6 5 型负极本体	4.7mm~6.0mm	A4-MU U 型公端子	2.5mm <sup>2</sup> ~6mm <sup>2</sup>	A4-FU U 型母端子	2.5mm <sup>2</sup> ~6mm <sup>2</sup>
A4-M7 7 型负极本体	5.6mm~7.0mm	A4-F7 6 型负极本体	5.6mm~7.0mm	A4-MO-10 O 型公端子	6mm <sup>2</sup> ~10mm <sup>2</sup>	A4-FO-10 O 型母端子	6mm <sup>2</sup> ~10mm <sup>2</sup>
A4-M9 9 型负极本体	6.8mm~8.7mm	A4-F9 9 型负极本体	6.8mm~8.7mm	A4-MO-16 O 型公端子	16mm <sup>2</sup>	A4-FO-16 O 型母端子	16mm <sup>2</sup>
A4-M10 10 型负极本体	8.0mm~10mm	A4-F10 9 型负极本体	8.0mm~10mm				



Super Series A4-S

Super 系列:光伏铜线连接器 A4-S



IEC 1500V  
UL 1500V



UL: 6703  
IEC: 62852



-40℃~90℃



UL94-V0



IP 68



UV Resistance



Male Connector Housing 连接器负极本体	Female Connector Housing 正极本体	Male Terminal 负极导电体	Female Terminal 正极导电体	Terminal Package 导电体包装
<input type="checkbox"/> M6:A4-M6	<input type="checkbox"/> F6:A4-F6	<input type="checkbox"/> MU:A4-MU	<input type="checkbox"/> FU:A4-FU	<input type="checkbox"/> B:Terminal in bags
<input type="checkbox"/> M7:A4-M7	<input type="checkbox"/> F7:A4-F7	<input type="checkbox"/> MO10:A4-MO-10	<input type="checkbox"/> FO10:A4-FO-10	
<input type="checkbox"/> M9:A4-M9	<input type="checkbox"/> F9:A4-F9	<input type="checkbox"/> MO16:A4-MO-16	<input type="checkbox"/> FO16:A4-FO-16	
<input type="checkbox"/> M10:A4-M10	<input type="checkbox"/> F10:A4-F10			

\* Customized options available, for more information, please contact NIU Power's team: [Marketing@niu-power.com](mailto:Marketing@niu-power.com).



Type U Male Terminal

U 型 公端子



Type O Male Terminal

O 型 公端子

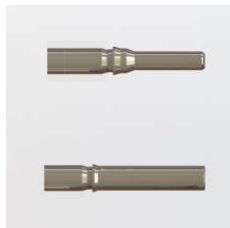

Type U Female Terminal

U 型 母端子



Type O Female Terminal

O 型 母端子

Package Info 包装信息:



Carton Dimension (cm)	Pack list	QTY	Gross Weight (kg)
59cm X 39cm X 18cm	Male Housing	500 pcs	16kg
	Female Housing	500 pcs	
	Male terminal	500 pcs	
	Female terminal	500 pcs	
Remark: 500 pairs in one carton package			

