

RF4

FOCUS DESIGN AND CONCEPT



RF-2KC1

Industrial camera manual

工业相机说明书

HDMI industrial camera has movable 8 horizontal lines or 8 vertical lines, which can be selected through the menu from 1 to 8, HDMI output maximum resolution of 1920x1080 60Hz. To ensure your safety, read the operation instructions carefully.

Packing parts: One industrial camera host, one 12V or 5V DC power supply, one remote control, one operating manual.

Interface and key functions :

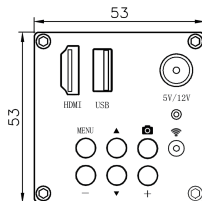

HDMI: Monitor HDMI cable interface

USB: USB drive port

5V/12V : 12V or 5V DC power port

: Take a picture/hold for 2 seconds to record

MENU: single key/store preview of main course

Installation:

The industrial lens is installed in the CS interface of the camera, the HDMI OUT interface is connected to the display data cable, the 12V DC interface is connected to the 12V or 5V DC power cable, and the indicator light is green after the power on, indicating that the camera has been working normally.

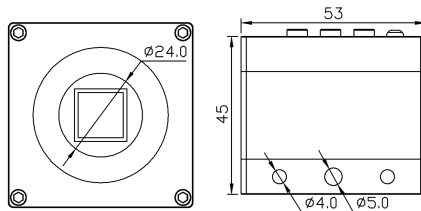

Menu operation:

Press the MENU key once to open the main menu. After opening the main menu, you can see image parameters, function Settings, device management, pop up disk and exit the sub-menu. Use the $\blacktriangle/\blacktriangledown$ key to move the cursor to select the submenu to enter, and then press the + key to enter the submenu to which the cursor points. Enter the submenu and press +/- to adjust the value. The default value in image parameters is "Automatic white balance", so "one-click white balance" is required. First set "Automatic white balance" to "NO", put a piece of white paper under the lens, and then trigger "one-click white balance".

Common problems and solutions:

1. Restore factory Settings: MEMU key - > Equipment Management - > equipment management->Comeback factory setup.
2. One key white balance: MEMU key - > Image parameters - > Auto White Balance (set to NO) - > Trigger the "one click white Balance" option.
3.  key use: press once for image capture; Hold down for 2 seconds to record the video (REC flashes to the left of the drive letter), and hold down for 2 seconds to end the video recording.
4. Image preview button: Press the MEMU key twice for image/video preview interface, and enter the corresponding image/video preview with the "▲/▼/+/-" key.
5. line color change: MEMU key - >Function Settings - > Left and right buttons adjust line color (set to YES) - > Exit through the "▲/▼" key adjustment.
6. LCD display screen is incomplete, black edge, please press the AUTO button on the display.
7. If there is dust on the lens or imaging component, please clean it with anhydrous alcohol (anhydrous alcohol) or wipe it off with glasses cloth.

Camera parameters:

1. Imaging element 2K 1/2.8 inch CMOS, effective pixel 1920X1080, frame rate 60 frames/SEC, resolution 900 lines.
2. Using CS lens interface, can choose any CS lens interface.
3. Power input: +5V to +12V DC, +5V maximum working current 400mA, +12V maximum working current 200mA.

HDMI工业相机有可移动8条横线或8条竖线，可通过菜单选用其中1到8条，HDMI输出最高分辨率为1920x1080 60Hz。为了确保安全，请详细阅读操作说明。

包装部件： 工业相机主机一台，12V或5V DC电源一个，遥控器一个，使用操作说明书一份。

接口和按键功能：

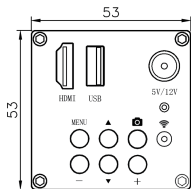

HDMI：显示器HDMI线接口

USB：U盘接口

5V/12V：12V或5V DC电源接口

：拍照/长按2秒录像

MENU：主菜单键/存储预览

▲：选项光标上移/线选择

▼：选项光标下移/线选择

-：选项的数值减/线移动

++：选项的数值加/确定/线移动

安装:

工业镜头安装在相机的CS接口， HDMI OUT接口和显示器数据线连接，12V DC接口和12V 或5V DC电源线连接，通上电后指示灯为绿色，说明相机已经正常工作。

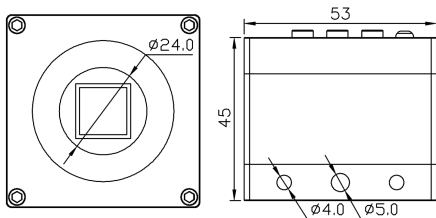

菜单操作:

按一次MEMU键打开主菜单，打开主菜单后，可以看到图像参数、功能设置、设备管理、弹出磁盘、退出子菜单。通过▲/▼键来移动光标去选择要进入的子菜单，再按+键进入光标所指向的子菜单。进入子菜单后通过“+/-”键来调节数值。图像参数内默认为“自动白平衡”，需要做“一键白平衡”，先把“自动白平衡”设置为‘NO’，在镜头下放一张白纸，再触发一下“一键白平衡”项。

常见问题和解决方法:

1. 恢复出厂设置：MEMU键->设备管理->复出厂设置。
2. 一键白平衡：MEMU键->图像参数->自动白平衡（设置为NO）->触发一下“一键白平衡”选项。
3. 📷 键使用：按一次为图像抓拍；长按2秒为录像（盘符左边有REC闪烁提示），长按2秒为结束录像。
4. 图片预览键：按两次MEMU键进行图片/视频预览界面，结合“▲/▼/+/-”键进入相应图片/视频预览。
5. 线颜色变更：MEMU键->功能设置->左右按键调节线颜色（设置为YES）->退出通过“▲/▼”键调节。
6. 液晶显示器显示画面不全、有黑边,请按显示器上的AUTO按键。
7. 镜头或成像元件有灰尘，请用无水酒精（无水乙醇）清洗或用眼镜布擦掉。

相机参数:

1. 成像元件2k 1/2.8英寸CMOS,有效像素1920X1080，帧率60帧/秒,清晰度900线。
2. 采用CS镜头接口，可以选用任意CS接口的镜头。
3. 电源输入：+5V到+12V DC，+5V时最大工作电流400mA，+12V时最大工作电流200mA。